

XTOOL

스탠드형 셀프서비스 키오스크

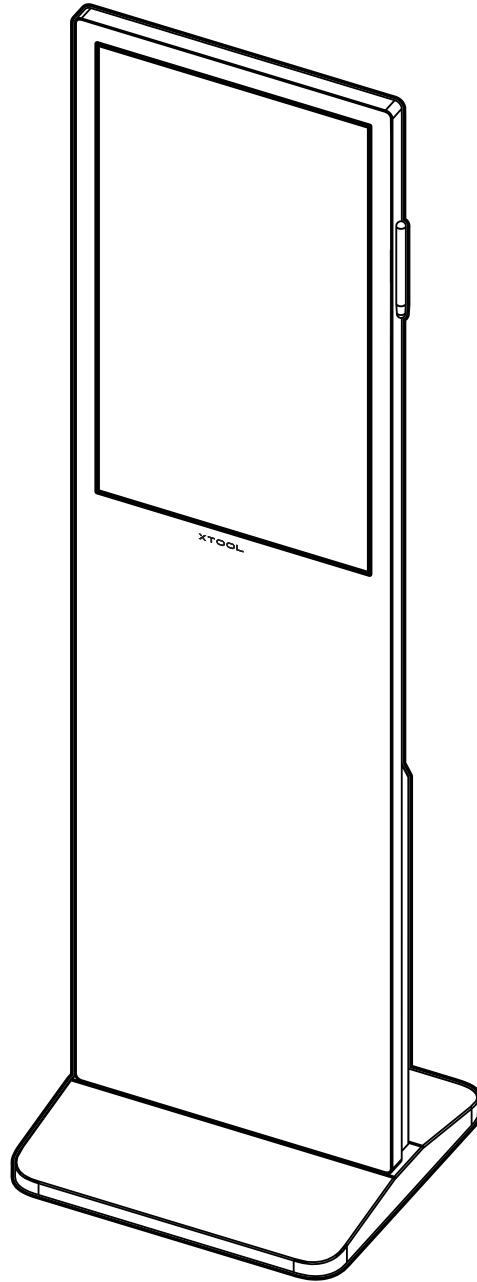

빠른 시작 가이드

항목 목록 ----- 01

스탠드형 xTool 셀프서비스 키오스크 알아보기 ----- 02

스탠드형 xTool 셀프서비스 키오스크의 설치법 -----04

스탠드형 xTool 셀프서비스 키오스크의 사용법 ----- 06

항목 목록

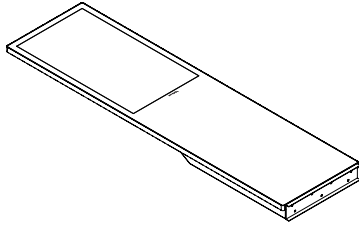

셀프서비스 키오스크

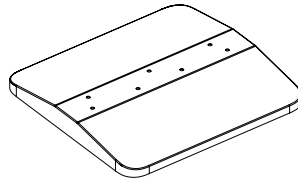

지지대

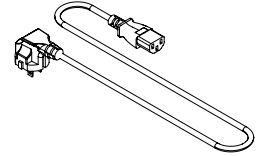

전원케이블

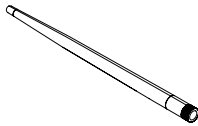

안테나

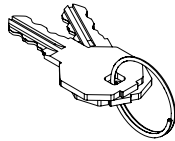

유지보수용 키

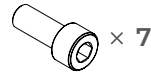

나사

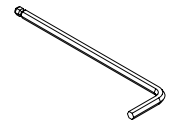

육각 키

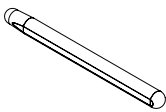

스타일러스 펜



빠른 시작 가이드

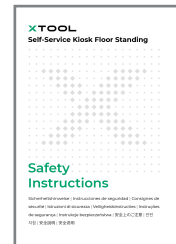

안전 지침



전원 케이블은 제품이 배송되는 지역에 따라 다릅니다.

스탠드형 xTool 셀프서비스 키오스크 알아보기

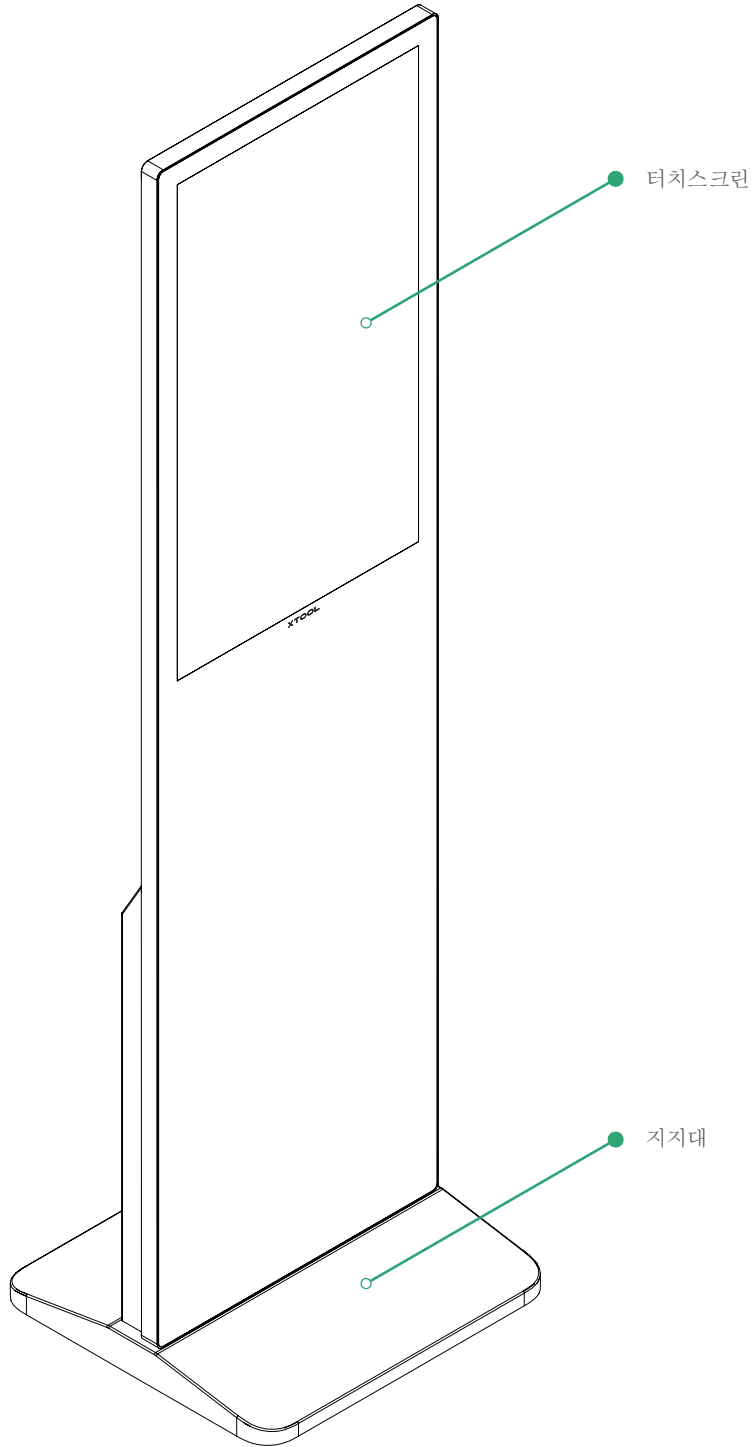

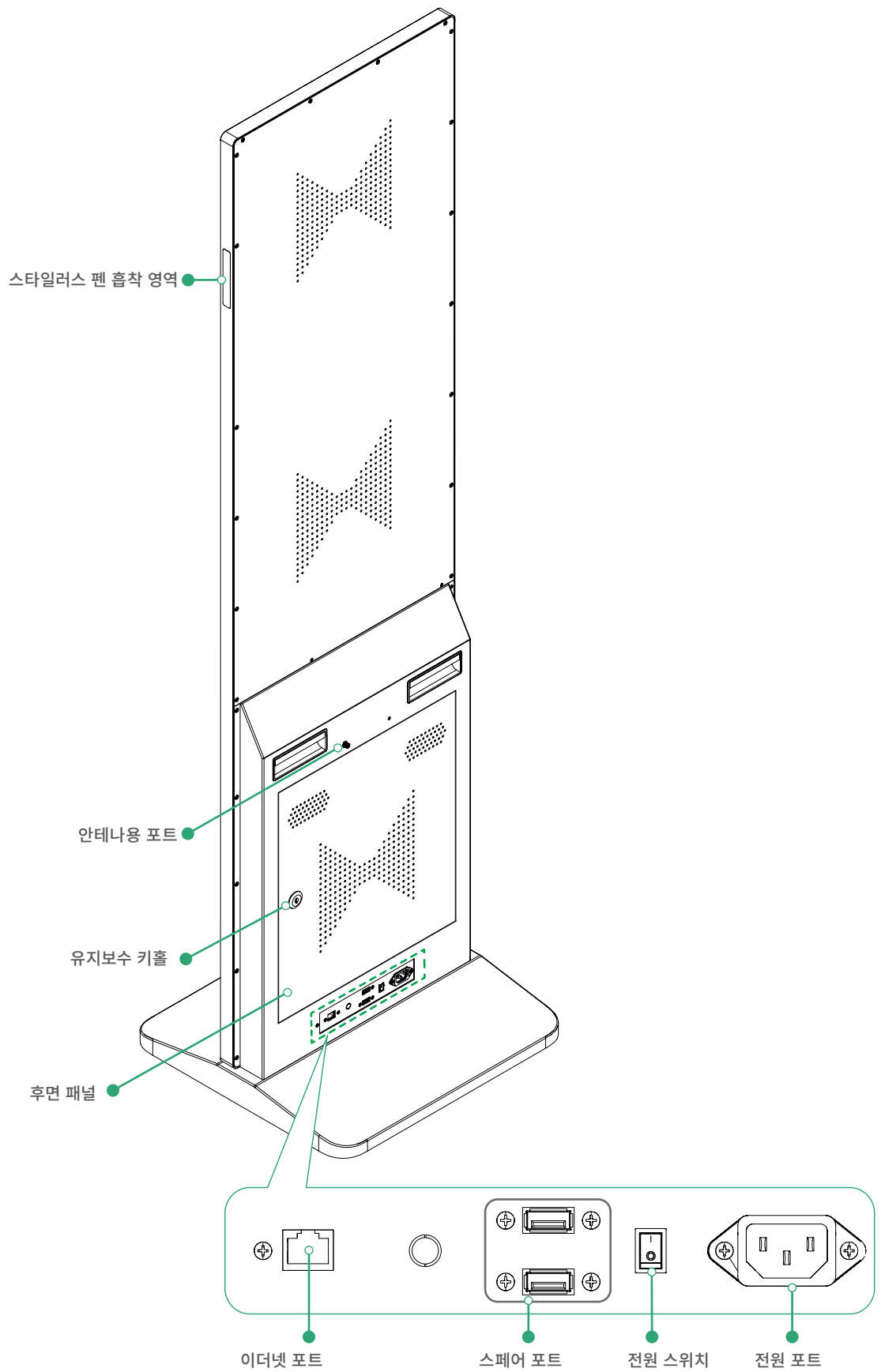

 후면 패널은 수리 시에만 유지보수 키를 사용하여 열 수 있습니다.

스탠드형 xTool 셀프서비스 키오스크의 설치법

1 지지대를 설치합니다.

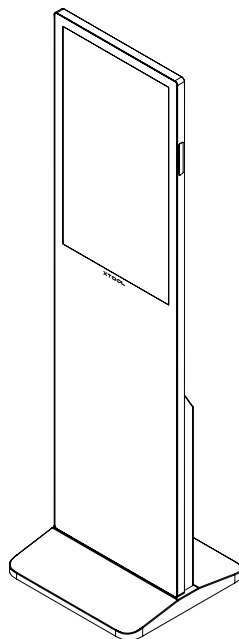
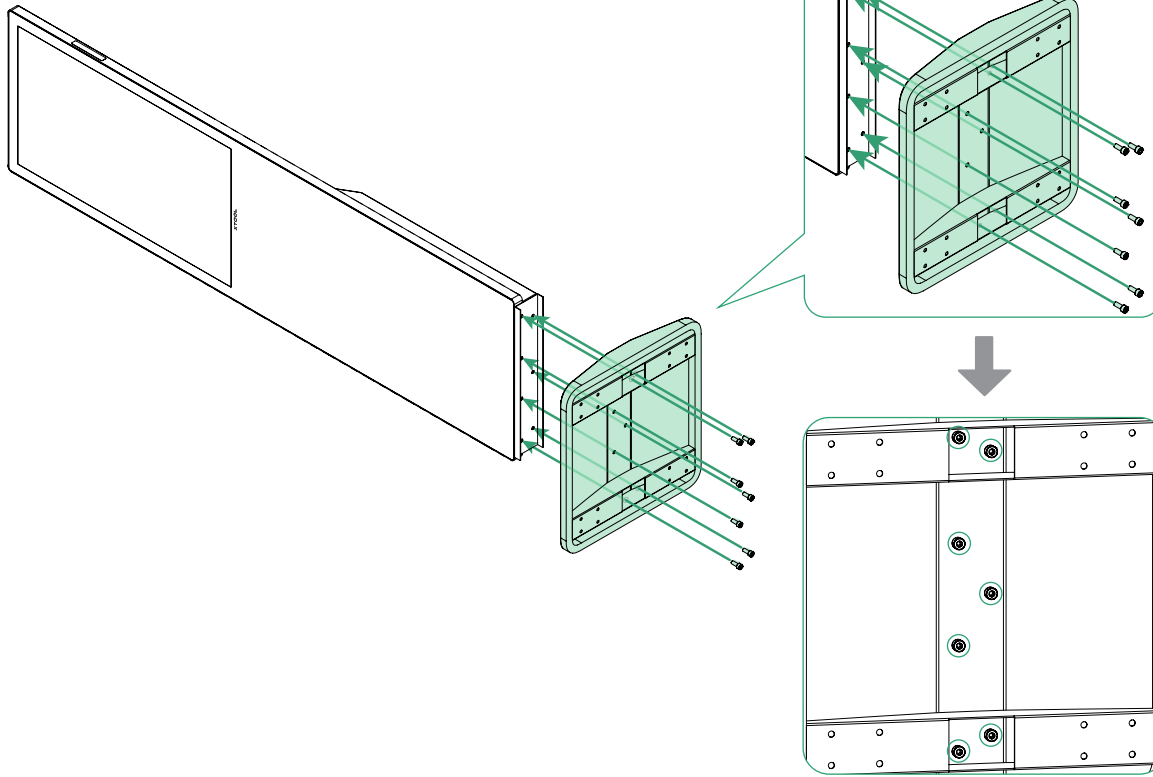
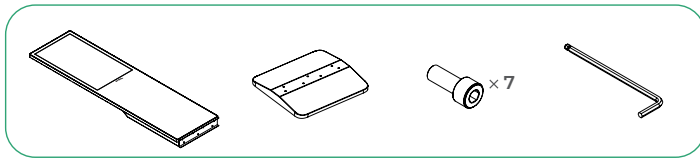

2 안테나를 설치합니다.

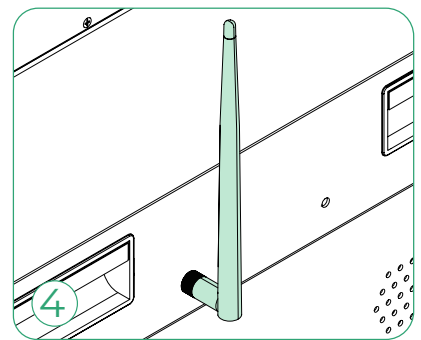
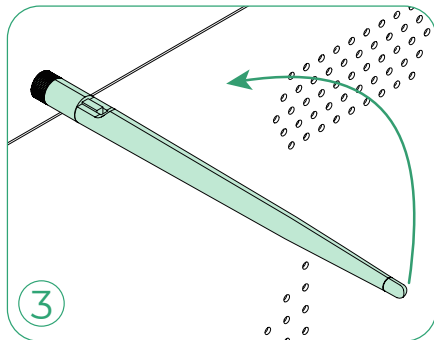
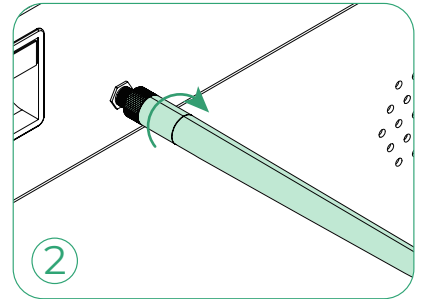
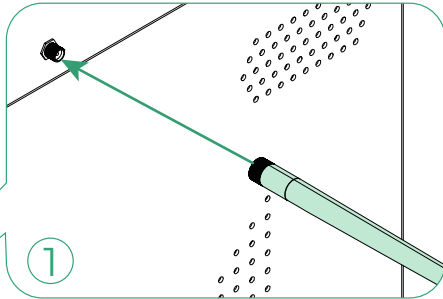
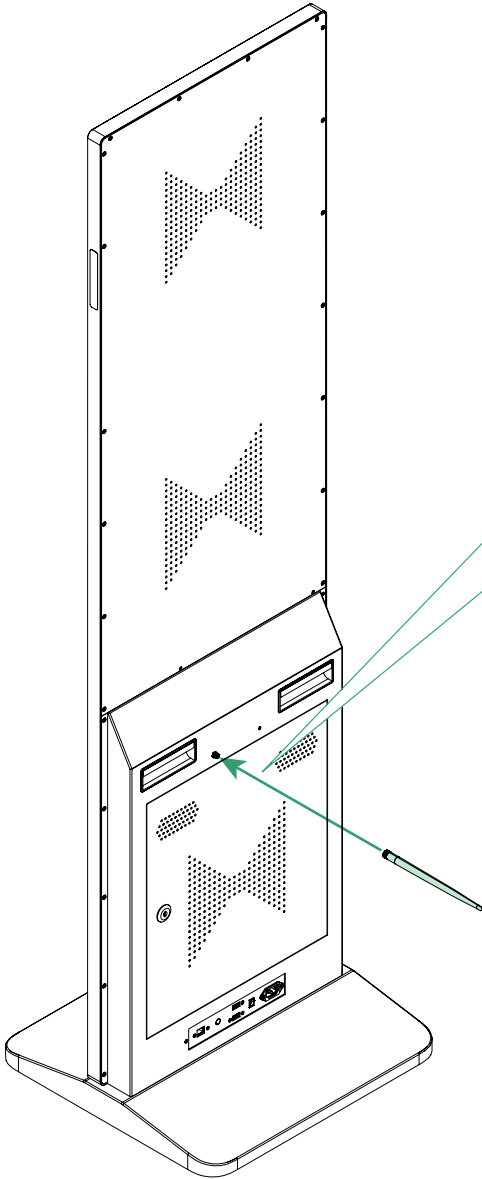
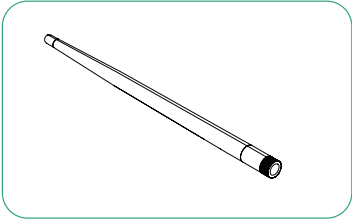

스탠드형 xTool 셀프서비스 키오스크의 사용법

전원 케이블을 연결하고 키오스크를 켭니다

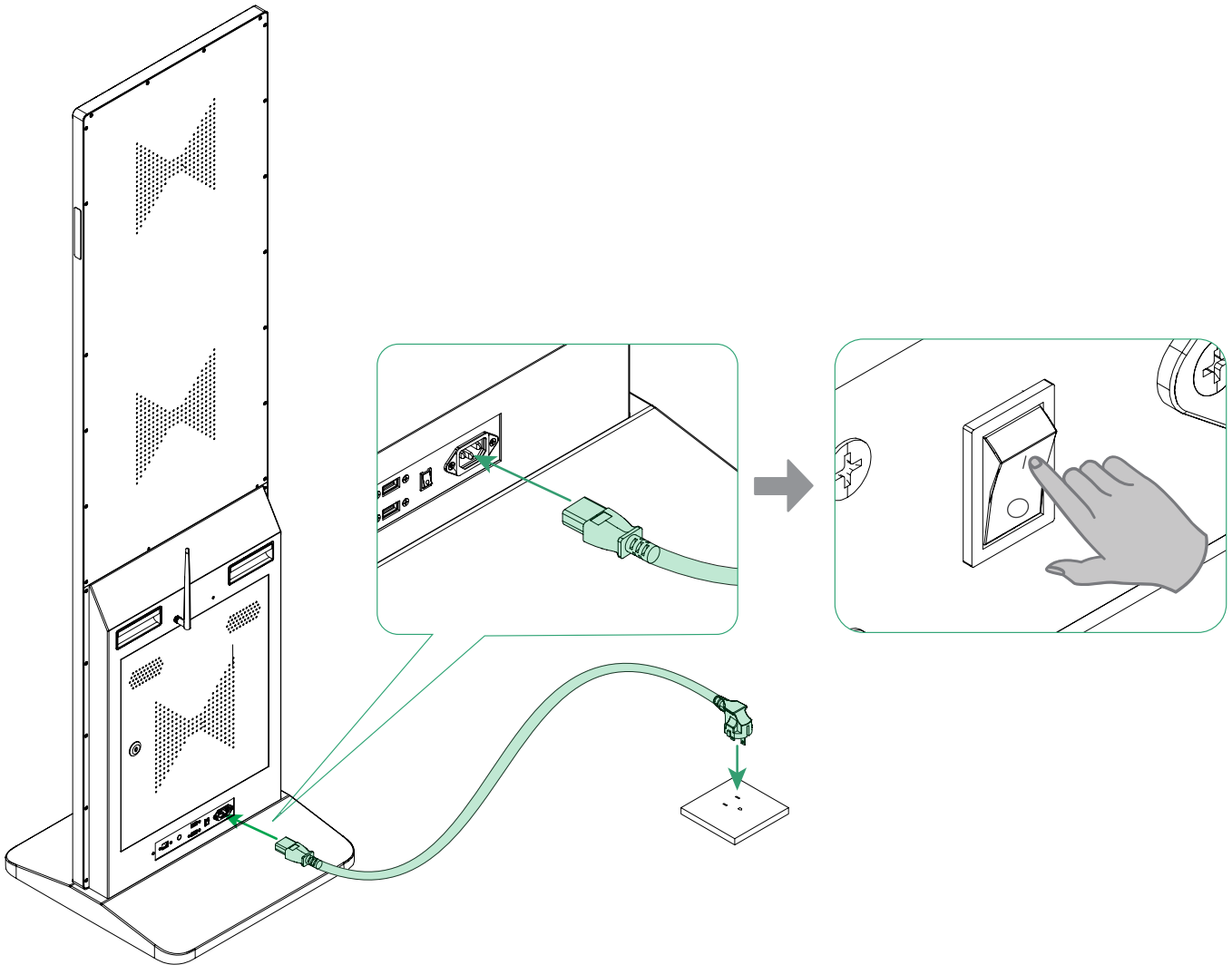
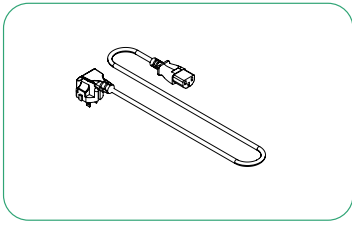

QR 코드를 스캔하거나 제공된 링크를 방문하여 xTool 기계로 제품을 가공하는 방법을 알아보세요.



support.xtool.com/article/2087

XTOOL